



Installation Instructions

81166

2013-21* RAM 1500

*Will carry on through Ram 1500 Classic Models only

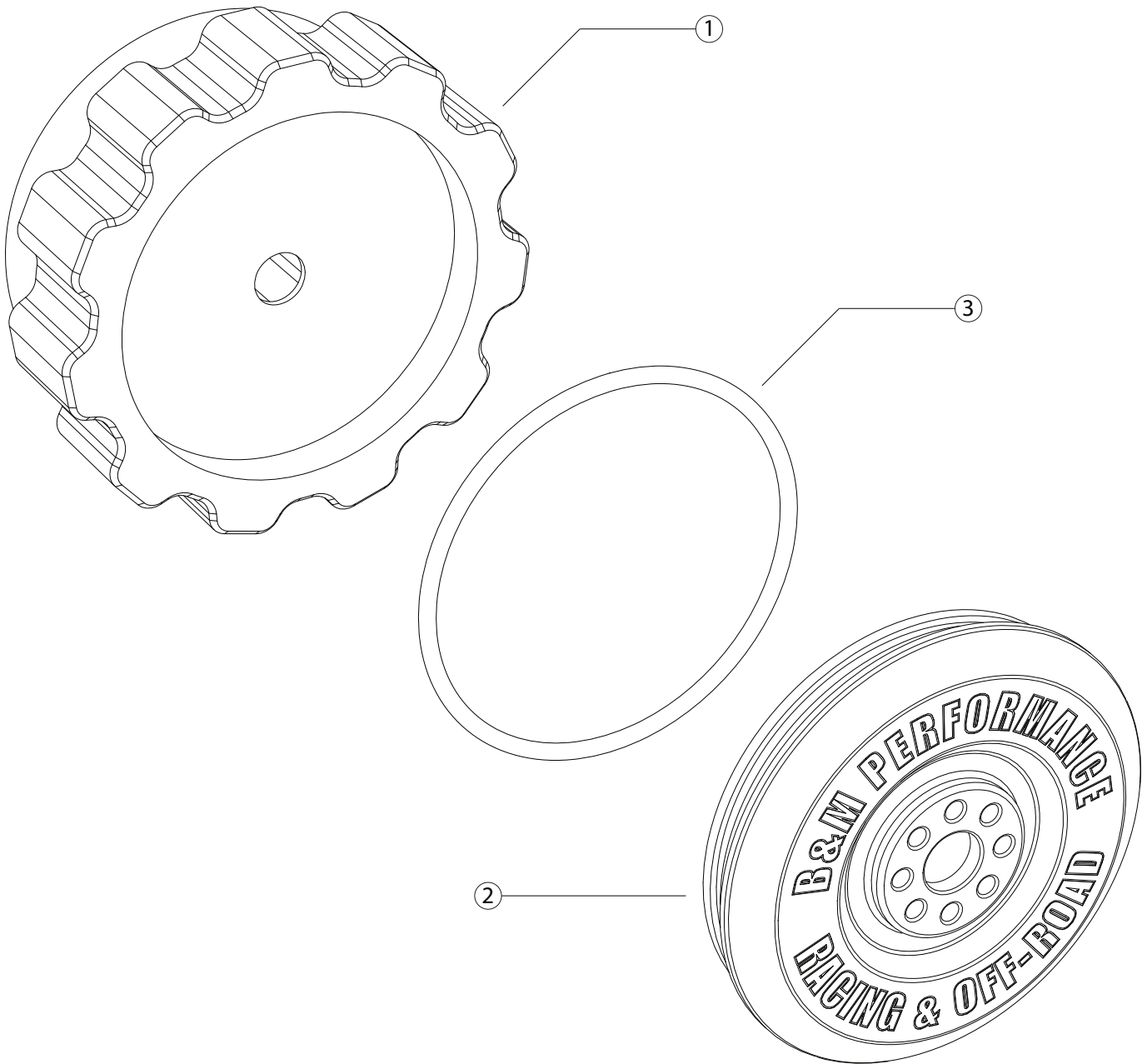

ITM #	PART #	DESCRIPTION	QTY.
1	4001778-88	Shifter Knob	1
2	4001779-88	Knob Insert	1
3	3401595-00	O-Ring	1

OVERVIEW:

1. Please take a moment to read and understand these instructions before installing your Flowmaster performance system.

NOTE: Please inventory all parts before starting the installation process and call our tech line to report any missing parts. This will help avoid potentially stranding your vehicle until any missing replacement parts arrive.

REMOVE STOCK SHIFTER KNOB:

NOTE: Turn your vehicle off and set parking brake before beginning install of your B&M Shifter Knob/Selector Dial.



2. Unseat factory knob insert. Remove shifter knob insert.



3. Remove screw from shifter knob then remove shifter knob from dial stem.

INSTALL B&M SHIFTER DIAL KNOB:

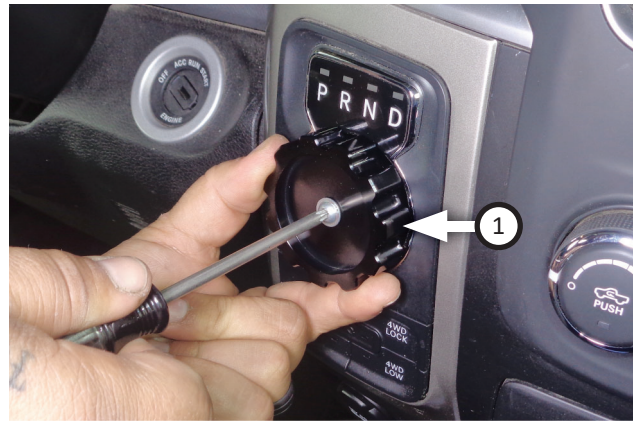

4. Set shifter knob (1) onto dial stem then fasten using screw (removed step 3).



NOTE: Applying lubricant to O-ring will ease insert installation onto shifter knob.

5. Fit O-Ring (3) into groove on knob insert (2). Then set knob insert onto shifter knob and push until it is fully seated.



Congratulations, the installation of your B&M Shifter Knob/Selector Dial is now complete!

